

WRYOA & WRCF Presents

Celebrate Festival

Whalley Range

Celebrating the UN International Volunteer Year
Connect with your Community

Monday 4th May 2026, 12-6 pm
JNR8, Cromwell Ave, M16 0BG

Music, Installations & Performances,
Stalls, Food & Drink, Inflatables,
Arts & Crafts, Age-friendly and Health & Wellbeing activities
Big Bike Revival repair & ride area

Full programme here-

<https://www.whalleyrange.org/whalley-range-celebrate/>

email: celebratewhalleyrange@gmail.com // phone: 0161 881 3744

whalleyrange.org // wryoa.org

[f @celebratefestivalwhalleyrange](https://www.facebook.com/celebratefestivalwhalleyrange)



A & F HARDWARE

Household - Key Cutting

Plumbing, Electrical

Fancy Goods

Open Mon - Sat, 9:00am - 6:30pm

Sun 10:00am - 5:30pm

Supporting Celebrate for 27 years!

264 Upper Chorlton Rd, Tel: 0161 860 0500



CO OP

We thank our 2026 Co-op partner for their continued support by contributing towards refreshments for the festival volunteers.

RUSSELL GARAGE

Motor Engineers

Proprietor: Dean Hole

Chassis Welding Specialists

Insurance Estimates

Servicing, MOTs and more...

Most Repairs to Most Cars

Tel: 0161 881 4466

31a Russell Rd, Whalley Range



Bembe Café is celebrating with you this festival season. Swing by for freshly baked treats, warming soups, freshly prepared sandwiches and the kind of welcome you only get somewhere that's been part of this community for years.



We're not just a café.

We're your neighbours

Halal | Always homemade

Find us at Alexander Park, Whalley Range M16 8PJ

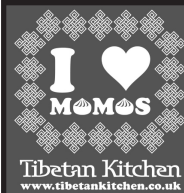

tibetankitchen

authentic
tibetan food

**Proud to be part of our vibrant
Whalley Range Community**

**Celebrating 17 years in Whalley Range,
launching at Celebrate Festival in 2009**

254 Upper Chorlton Road, 0161 881 1966

www.tibetankitchen.co.uk

elliotts pharmacy

WE WILL COLLECT YOUR PRESCRIPTION AND DELIVER FOR FREE!

**YOUR LOCAL FAMILY RUN PHARMACY
involved with Celebrate for 29 years!**

201 UPPER CHORLTON RD, WHALLEY RANGE

TEL: 0161 881 9800

Celebrate

Festival

Whalley Range

A very warm welcome to the 29th Celebrate Festival, celebrating the very best of our fantastic community. In recent years the Festival has been in Manley Park and we hope to return there next year, but this time round the funding position means we are holding another compact Festival in and around our JNR8 base. We are grateful to Manchester City Council and our local councillors without whom the Festival would not be taking place at all. Although the Festival may be smaller than usual you will still find a great programme of music, workshops and activities that reflect the diverse and talented nature of Whalley Range.



The theme of the festival this year is 'Connect with your Community', marking the UN Year of Volunteering. It's a great opportunity to build stronger and more resilient community connections and to find out more about what's happening locally.

Check the map and schedules to see what's going on. We have music and performance on two stages, drop in creative activities in the Arts & Crafts Marquee and lots of activities and information in the JNR8 hall.



In the grounds you will find inflatables, a drum circle, storytelling and puppets in the lovely Montessori House garden, bubbles with Cequin Circus, facepainting, and MAD Sustainable Design who invite you to complete some Quests!

In the run-up to the festival, our artists have been busy running workshops with local schools and community groups. Lotte Karlsen has led textile workshops with Time to Change and the Leg Up Club at JNR8, as well as with all three local primary schools. Jo Capstick/Mobious Jo ran pre-festival preparation for the benches art folders, as well as running activities on the day. Becky Lattin has led cyanotype printing workshops with Whalley Range Women's Group and the Crafternoon group at JNR8. Both will be running workshops on the day, and you can see their work displayed in the Arts Tent or at JNR8. The Vibe Bombers also made a festival warm-up appearance in Manley Park, and there have been free pre-festival daytime activities at JNR8.

The festival is made possible by donations from local businesses, fundraising by volunteers and grants from various funders



The Aims of Celebrate:



- To celebrate the talent, diversity and resources of Whalley Range
- To promote a positive image and improve the quality of life in Whalley Range
- To encourage participation of different communities within the area and work from an anti-discriminatory framework

If you want to get involved with Celebrate, WRYOA or WRCF, contact us at:
celebratewhalleyrange@gmail.com or 0161 881 3744
or come and have a word with us at the Information Stall



The Alexandra Practice and Princess Road Surgery

Offering GP Services across both sites. New patients welcome!

Long time supporters of Celebrate! We aim to bring all members of the community together to promote good health. We are part of Whalley Range Clean Air group of local organisations.

Alexandra Medical Practice, 365 Wilbraham Road, Whalley Range, M16 8NG Tel: 0161 860 4400
www.thealexandrapractice.nhs.uk

Princess Road Surgery, 471-475 Princess Road, Withington, M20 1BH Tel: 0161 445 7805
www.princessroadsurgery.co.uk



A modern South Asian canteen serving bold, honest flavours inspired by home cooking and street food. Enjoy a daily-changing menu of wholesome curries, fresh sides, and signature Thai-style meals with meat, veg., and vegan options. Where comfort food meets contemporary canteen culture.

Our new range of kebabs will be on sale at Celebrate.

209 Upper Chorlton Road, Whalley Range
Contact: Info@Kaana.co.uk

Acknowledgements

The festival is run by volunteers from the community, staff and volunteers from Whalley Range Youth Opportunities Association, and Whalley Range Community Forum.

We are grateful for the professional assistance of our project coordinators and artists.

Festival Coordinator: **Jess Coulson**



Let's Clean Our Air!



Get involved with our activities to make a big noise about clean air in Whalley Range.



Chat with one of our giant puppets at Celebrate.



Clean Air Day 18th June - Join our banner display over Princess Parkway
21st June - Join our Clean Air walk to Alexandra Park and picnic 2-4pm
Meet our giant puppets and join in the picnic - bring food and rug to sit on.



Find out more on our website <https://wrceag.org/clean-air-day>



FREE!

SESSIONS BY QUALIFIED MECHANICS, INSTRUCTORS AND RIDE LEADERS
FOR ADULT BEGINNERS, IMPROVING OR RETURNING TO CYCLING



The **BIG BIKE**
Revival



FREE!



As part of the **Big Bike Revival**, Time to Change, with Bike Hive from Alexandra Park, are delivering FIX sessions at JNR8 Youth and Community Centre, Cromwell Ave:
May 4th (Celebrate Festival)
and on 15th, 22nd, 29th May, and 5th June 4-7pm



THE BIKE HIVE

Contact Carol on 07788 855544 or see FaceBook 'Big Bike Revival Whalley Range'



INDOOR AGE FRIENDLY / HEALTH AND WELL-BEING AREA:



- KPS Pharmacy BP and health checks
- Textile bench folders with Common Cloth CIC
- Hand and arm massage by **Loha Angel Hands**
- Chair yoga and mindfulness with **Manc Yogi**
- Exhibition - Curiosity - what we can learn from each other by St Margaret's Primary School

Information to take away from:

- Whalley Range Community Forum • Cost of Living advice and information
- Age Friendly Whalley Range & Chorlton
- Find out about the Leg Up club at JNR8 • Sickle Cell Care Manchester
- Safehouses Fostering • PSS Shared Lives

IN THE ARTS N CRAFTS TENT:



- Carpet collage with **Gulnaz Fatima** • Media collage with **Nayna Lad**
- Cyanotype printing with **Becky Lattin** • Fabric printing with **Lotte Karlsen**
- Make your own zine with **Georgina Fox** • Creative surprises with **Thea Luckock**

IN THE GARDEN... explore the garden with lots to do, buy and try

- Bubbles for All by Cequin Circus • Bird Box Volunteer Tree
- Inflatables • Facepainting with Sunita
- Drumming with Karim • Pipe cleaner flower making with Girls from Whiz
- Handmade craft and food stalls, including Chloe Watts Art Prints Bembe Cafe, India Share, and Kaana South Asian Canteen
- Manley Park Methodist Church offering cakes and conversations
- Side Quests with Mad Sustainable Designs - chaotic adventures for kids

MONTESSORI GARDEN... come and play and listen to stories

- Senegalese Stories with Karim Mbaye
- Remy Rainbow Puppet show with Iona Garrow
- Animals and Creation Myths with Iris Skipworth



ON CROMWELL AVENUE / EGERTON ROAD NORTH

- Tibetan Kitchen food cart
- Coffee Cranks coffee bike
- Fire Engine from Moss Side Fire Station – unless there's a fire to attend!



What's going on at **JNR8** Youth & Community Centre

Whalley Range Community Forum
JNR8 - 0161 881 3744
<https://whalleyrange.org>



Whalley Range Community Forum is a representative voluntary organisation for residents of Whalley Range.

The Age-friendly Whalley Range and Chorlton steering group hold meetings and social information events to engage with older people to identify and address priorities.

Daily advice, signposting, foodbank referrals
Mondays

11-12:30pm Whalley Range Women's Group

1-2:30pm Creative Conversations craft and chat group

Tuesdays

12-2pm JNR8 50+ music group

2:15-3pm Chair exercise for mobility

Wednesdays

10-11am Women's Keep Fit

11:45-1:30pm Leg Up club: support/social for people with health conditions/isolation

2-3pm Age-friendly cuppa

Thursdays

11:30-1pm Spanish group

Fridays

10-1pm Community Hub:

Tea & toast/soup, support and chat

1-2 pm Boost resilience (call to book)

Contact details:

communityforumwhalleyrange@gmail.com

agefriendlywhalleyrange@gmail.com

Fridays - Time to Change

Mental Wellbeing Social Group- **5 till 7pm**

Call Carol for more info on 07788 855544

Supporting Mental Health

Come along and join us in:
 cooking/eating, pool, live music,
 and some good conversation.

Promoting positive messages!



let's end mental health discrimination

WHIZ Youth Project **Ages 11-19 years**

Facilitating the personal, social and educational development of young people



Monday - Girls Group *The 'girls only' group is back!*
 Come along and tell us what you'd like to see happening

Tuesday - Muay Thai Boxing
 + In house activities

Wednesday
 In house activities

Thursday - Fitness Session
 + In house activities

In-house activities: Pool, PS4, Board Games, Basket ball, Table Tennis, Art & Crafts, AND.... much more!



WHALLEY RANGE YOUTH OPPORTUNITIES ASSOCIATION
 Charity No. 12066

- Volunteering Opportunities

- One to One Support

- Outdoor Activities

0161 881 3744 - CV/ Job Application support

www.wryoa.org - Group Workshops

JNR8 PLAY SCHEME

WRYOA's fantastic play scheme runs during school holidays, for children ages 6-12yrs old.

Looking forward to the Summer holidays!
 30th July till 20th August (Mon-Thur)



Community on Solid Ground Youth Club Ages 8-19 years



Every Saturday 6:00-9:00pm

www.yosg.org.uk, 0161 862 0955

THANK YOU for ongoing support and contributions to:

Manchester City Council
 The National Lottery Community Fund
 Alexandra Medical Practice
 Whiz Youth Project staff and volunteers

Cycling UK
 The Cooperative
 Whalley Range Community Forum
 Age Friendly Whalley Range



MAIN STAGE - Indoors (In church)

- 12:20pm **Chorlton Rock Out School** (showcase for local youngsters)
- 13:00pm **St. Margarets Choir and violinists** - local school performance
- 13:45pm **Cave Man-** Hiphop Storytime combines live beatmaking, rap and poetry together into a journey through space and time
- 14:30pm **Chia Kali-** Jazzy soulful sounds
- 15:00pm **The Rosettes-** Chorlton trio mixing indie covers and originals.
- 15:50pm **The Magic Pennies-** Psychedelic folk rock with serious live energy
- 16:30pm **Open Voice Choir** (Whalley Range legends /Celebrate regulars)
- 17:00pm **Phellotape-** Double bass, vocals and sticky sounds



Jo Rose- Garden



- 12:15pm **Tony Curry-** presenting fresh local talent
- 12:30pm **Shelli Le Fay-** Ethereal folk from a woodland mystic
- 13:10pm **Anna Percy-** Wild feminist work shaped by love, loss and nature.
- 13:30pm **Dhol Mafia-** Dynamic rhythms bringing pure celebratory energy.
- 14:00pm **Colin Anderson-** Poetry rooted in family, observation & the obscure.
- 14:20pm Thai Boxing Demonstration by **WRYOA-Whiz Youth Project**
- 15:00pm **Jenny Pilkington-** Spoken word blending wit and upbringing.
- 16:30pm **Paddy Elliot Walker-** Upbeat soul and motown
- 17:10pm **Elliot Perlic-** Deep-feeling queer poetry with unmistakable good vibes.
- 17:30pm **Tony Curry-** presenting fresh local talent



Photographs and videos will be taken around the site by various people, throughout the day for monitoring and promotion purposes.



Bike Parking beside Cromwell Avenue door entrance



MAP

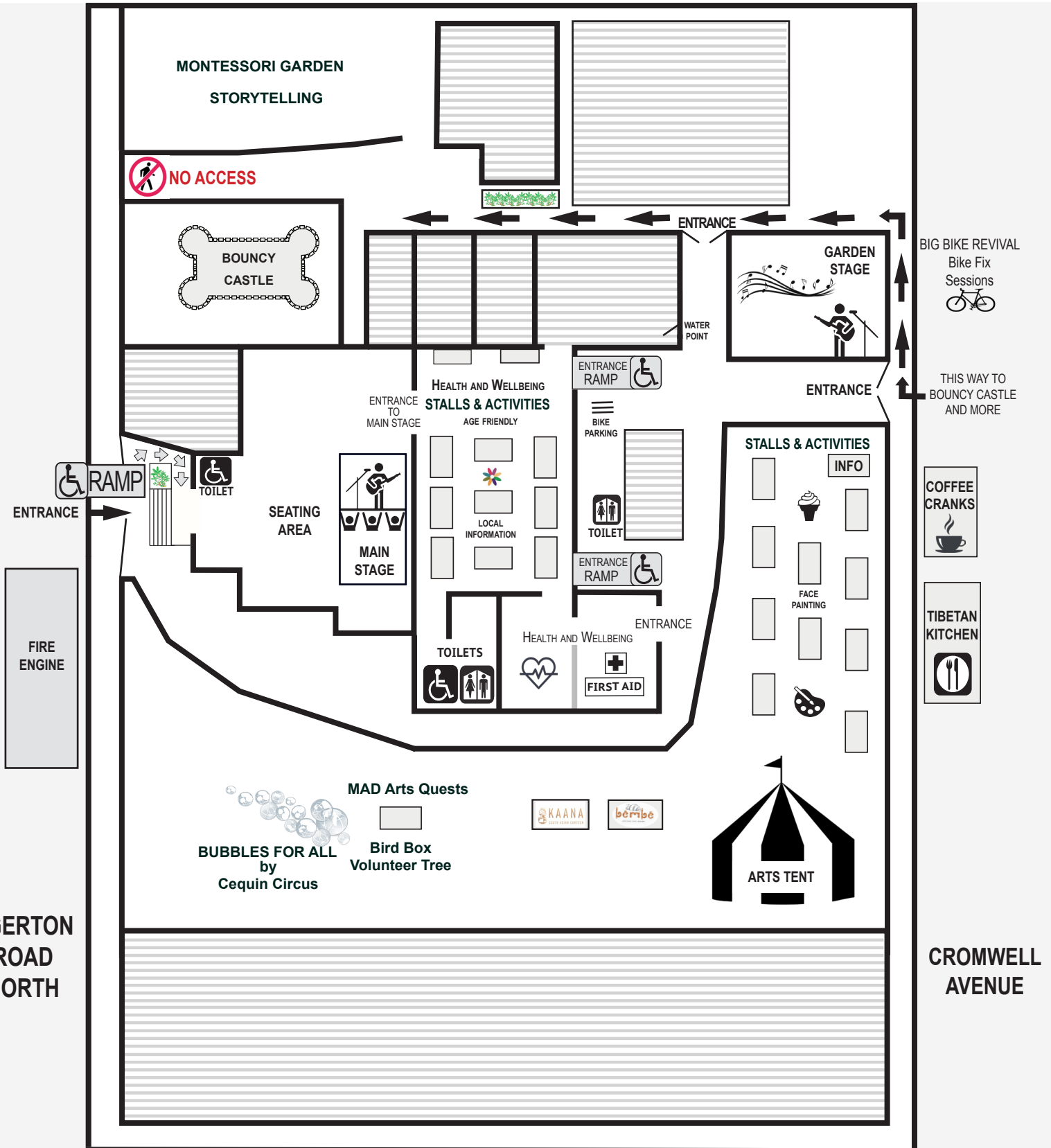

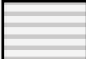
 **NO ACCESS AREAS**

 **STALLS / GAZEBOS**

CLARENDON ROAD